

# ELEVAH<sup>®</sup> 5 inox

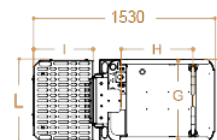

# ELEVAN<sup>®</sup> 5 INOX picking

Max. working height	5,15 m
Max capacity	200 kg
Number of people	1
Use	Internal - External
<b>A</b> Closed machine height	1690 mm
<b>B</b> Min. height from the ground*	289 mm
<b>C</b> Maximum platform height	3150 mm
<b>E</b> Base overall dimensions	700 mm
<b>F</b>	1152 mm
<b>G</b> Cage dimensions	630 mm
<b>H</b>	780 mm
Machine weight	640 kg (With electrical picking platform) 590 kg (With removable picking platform)
Drive wheels dimension	Ø 186 x 60 mm
Swivel wheels dimensions	Ø 150 x 40 mm

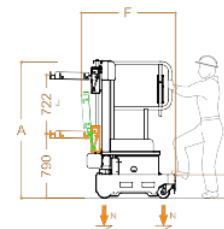

## PICKING PLATFORM

<b>I</b> Dimensions	500 mm
<b>L</b>	680 mm
Adjustment	Electrical
<b>J</b> Stroke	720 mm
Min. height from the ground	790 mm
Maximum height from the ground	4102 mm
Capacity	100 kg

## PERFORMANCE

Power supply	Electrical 24 V
Batteries	2 Trojan Lead-Acid 12V 105 Ah
Battery charger	110V – 230V 50/60HZ
<b>M</b> Maximum climbing ability	15%
Climbing ability at height	2,5%
Internal turning radius	0
External turning radius	2100 mm
Max. speed (rising – descending)	0,2 m/s
Maximum speed (with basket on the ground)	4,5 km/h
<b>N</b> Maximum pressure for wheel at full load**	3,10 kN
Work cycles (with fresh batteries) ***	100

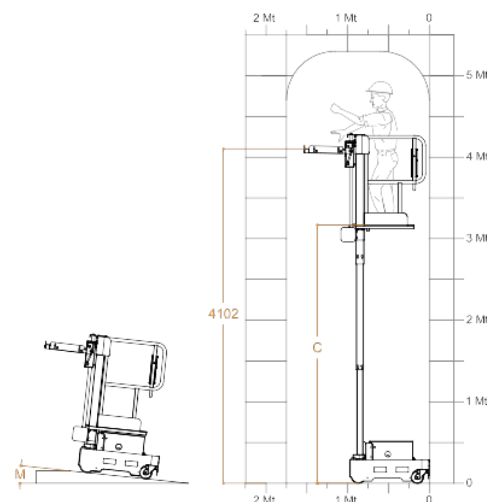

\* There is an intermediate step.

\*\* Maximum pressure whereas the weight of the platform plus the maximum load on the basket are completely distributed on one side of the platform (totally asymmetric load).

\*\*\* By work cycle we mean a self-propelled movement of 20 m with a full ascent to and descent from the maximum height and with adjustment of the loading platform.



Complies with European regulations for man-up forklift trucks. UNI EN ISO 3691-1.